

KEY FEATURES

- Series 168 Curtain Wall can be fabricated as a full aluminium system with thermal shielding or thermally broken mullions and transoms to achieve excellent energy efficiency and thermal performance values.
- Thermally broken system includes a 20mm wide true thermal break to maximise energy efficiency, achieving U_w values of 1.7
- An aluminium cap protects the thermal break from UV degradation caused by the aggressive Australian sun. The anodised aluminium cap is also an ideal adhesion surface for the silicone weather seal between glass and frame and provides protection from potential hail damage.
- Will accept Sun fin brackets, sun fin brackets don't puncture the mullion weather legs. The mullion thickened at Sun fin bracket fixing locations.
- Will accept insulating glass units (IGU's) up to 32mm thick or a custom spandrel adaptor reduces glass back to 6mm thick.
- 100% Australian designed, extruded and manufactured.

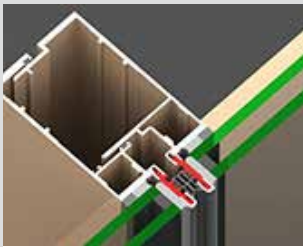

Incorproates a 20mm Thermal break to improve thermal performance - Acheives U_w Values as low as 1.7



The sun fin bracket is thermally isolated from the mullion, bracket will vary depending on sun fin design

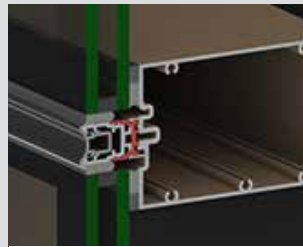

Thermally broken glass support fins protected with anodised aluminium cap to protect from intensive UV degradation.

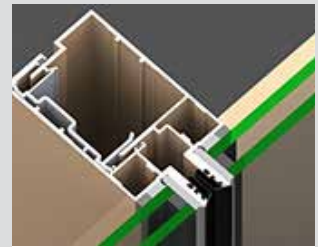

200mm long extruded aluminium retention brackets at mid span and 200mm up from the bottom reduces the risk of mullions seperating.

GENERAL

Max Panel Height
3600mm

Max Panel Width
1800mm

Max Glass Thickness
32mm

ENERGY

U_w Range
1.7 - 2.5

SHGC Range
0.22 - 0.33

WEATHER

Maximum Water
1124 Pa.

ACOUSTICS

This product has not been acoustics tested.