

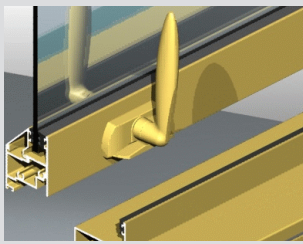

KEY FEATURES

- The MIRO™ Casement Latch is designed to suit residential, architectural and Elevate™ commercial awning and casement windows.
- This fastener is curved similar to a gum leaf.
- Available in a range of standard or special powder coat finishes.
- The retention wedge folds up to cam lever when opened. This is a significant feature in that there is no fixed keeper on the frame.
- Matching hinged door lever furniture.



CASEMENT COMPATIBLE

MIRO™ cam latch can be fitted to awning and casement sashes. The latch is available left or right hand.

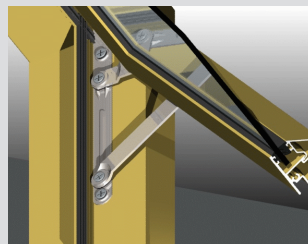

STRENGTH

We offer a range of heavy duty sashes that can be fabricated in large sizes and are supported on heavy duty four bar friction stays.

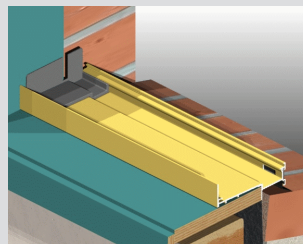

CUSTOM SUB-SILL

Elevate™ Commercial awning windows are fitted into custom sub-sill. This sub-sill is designed to go into residential installations.

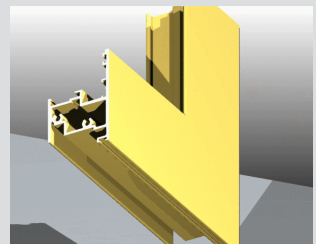







WATERPROOF

Elevate™ awning and casement sashes are fabricated with heavy duty nylon corner stakes. These keep the joints tight and waterproof.

DIMENSIONS

Height	35mm
Width	125mm
Depth	44mm

SUITABLE FOR USE WITH

-  Series 516 Residential Awning/Casement Window
-  Series 517 Residential Awning/Casement Window
-  Series 616 MAGNUM™ Awning/Casement Window
-  Series 726 ThermalHEART® Awning/Casement Window
-  Series 456 Commercial Awning Window
-  Series 466 Architectural Awning/Casement Window