

KEY FEATURES

- Series 726 awning window is designed to suit Australian building-in conditions. Nailing fins (weather bars), building-in lugs and the PVC sill flap assist in installation.
- Series 726 incorporates ThermalHEART® technology giving a true wide thermal break between the outside and inside faces. ThermalHEART® systems perform up to 32% better than traditional aluminium windows and doors.
- Designed to accept Truth™ hardware. This allows us to offer very large casements and awnings fitted with scissor type winders with jamb to stile latches that secure the sashes in the closed position.
- The Truth™ hardware can resist high negative wind loads with the use of winders and side latches.
- The window is compatible (appearance, strength and performance) with the high performance ThermalHEART® hinged, sliding and bi-fold doors.
- ThermalHEART® will accept insulating glass units up to 32mm thick. The typical IGU thickness is 24mm.
- Truth™ awning and casement will accept flyscreens.

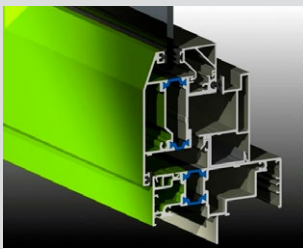

Sash designed to accept Truth™ hardware. An added benefit of colour separation possible with ThermalHEART® products - one colour inside and another outside.

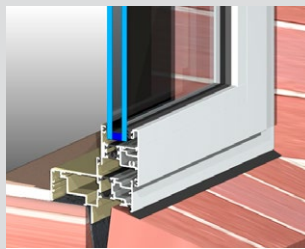

Double glazing is used as standard to obtain maximum thermal performance. Dual colour option available as shown above.

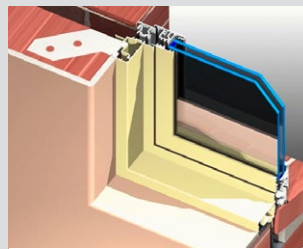

Custom building-in lugs secure the jamb to cavity brick wall.
2mm Radius on the internal corners softens the appearance.

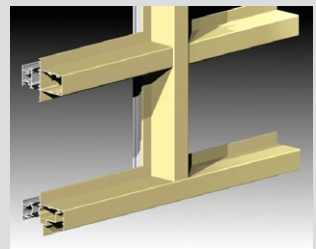

Mullions stop 2mm short of perimeter to suit the 2mm radius on perimeter. Likewise the transoms stop 2mm short of the mullions for the same reason

GENERAL

NB: Maximum panel height and width of Awning sashes are interdependent.

Max Panel Height*

A/ 2030mm
C/ 2030mm

Max Panel Width*

A/ 1200mm
C/ 1000mm

Max Glass Thickness

32mm

Frame Depth

100mm

ENERGY

UW Range
2.6-6.0

SHGC Range
0.18-0.47

WEATHER

Maximum Water
450 Pa.

ACOUSTICS

8.5mm VLam Hush™
/10/6.5 VLam Hush™
Rw 41 (-1;-5)

6.5mm VLam Hush™
/12/6 Tgh
Rw 40 (-1;-5)

Based on tests carried out on the standard Series 726 sash



*Dimensions subject to individual site conditions. A = Awning Configuration. C = Casement Configuration.