

DESIGNER SERIES | SERIES 618
MAGNUM™ SLIDING DOOR

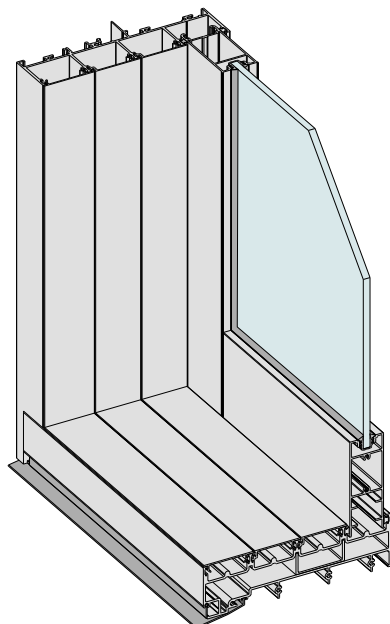

KEY FEATURES

- Stacking sliding door offering 2, 3 and 4 panel configurations or bi-parting doors up to 8 panels with dedicated cavity sliding option.
- The flat sill design allows the door frame to be recessed completely into the floor for the ultimate finish.
- The 33mm thick stiles are ideal for extra large doors (up to 3000mm) in high wind load areas.
- Tested to very high water resistance of 300Pa standard sill, 450Pa high performance sill and 660Pa cyclone sill, allowing these doors to be installed into most residential projects.
- 90° corner sliding option – no central meeting post.
- Optional stacking flydoor system nests into the main frame.
- For the ultimate screen this door system can be fitted with Centor™ retractable screen behind the glass doors.
- Unused frame recesses are closed off with snap-in flat fillers for improved appearance and water resistance.
- Heavy door panels use double or quad wheels, the quad wheels will support panels up to 250Kg.

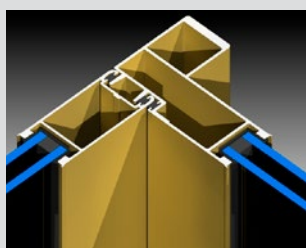

We offer this door in many configurations, including the 90° corner opening shown above. This illustration also shows the double glazing option.

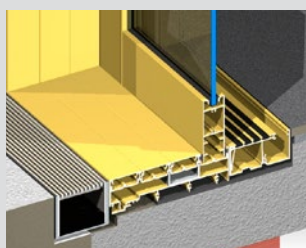

The above illustration shows the completely flat sill design. It features a four track XXXF flat sill with recessed sump on the outside and Centor™ roller screen on the inside.

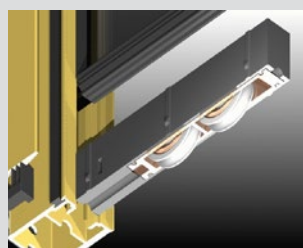

Heavy doors require heavy duty rollers. We fit double bogey wheels under heavy doors to ensure they slide smoothly for years to come.

Double bogey wheels shown above.



Mortice lock option with ANDO™ or ICON™ (shown above) pull handles and matching cylinder escutcheons, ANDO™ shown above. On heavy doors we recommend D-pulls.

GENERAL

Max Frame Height*
3000mm

Max Panel Width*
2000mm

Max Glass Thickness
24mm

Frame Depth
133.5mm-177.5mm

ENERGY

UW Range
3.0-6.2

SHGC Range
0.22-0.67

WEATHER

Maximum Water
400 Pa.
(standard sill 44mm)

450 Pa
(high performance
sill 50mm)

660 Pa.
(cyclone sill 70mm)

ACOUSTICS

6.38mm VLam Hush™
Rw32 (0;-2)

10.5mm VLam Hush™
Rw34 (0;-2)

6.5mm VLam Hush™
/8/ 5Tgh
Rw35 (-1;-4)



*Dimensions subject to individual site conditions.
BAL-40 compliance may limit glass options. Maximum glass size for BAL-40 products is 5m².

vantagealuminium.com.au/618