



# MUNRO LIBRARY

 LIGHT WITHIN THE PAGES

The redevelopment of the Narm Ngarrgu Library and Family Services in Melbourne is a cornerstone of the \$250M Queen Victoria Market Renewal. This eleven-storey facility features a variety of amenities, including a family services centre, creativity spaces, and shared study and meeting areas.

Six Degrees' design intent was led by sustainability and user-focused principles to create comfortable and functional spaces that reflected the city's vibrancy and community spirit, while celebrating cultural diversity and inclusion.

Six Degrees and Buildcorp chose SMB Windows & Doors for the job, and SMB opted to glaze the standout 45sq/m Skylight and Automatic Louvres in Series 626 Double Glazed FrontGLAZE™ framing. This skylight/louvre combination is specifically designed to release heat trapped in the building. The framing can accommodate Insulated Glass Units (IGUs) up to 24mm, enhancing thermal performance while maximising natural light cultivating bright and inviting spaces where creativity can thrive, and ideas can flow freely.

Additionally, the inclusion of Series 50 Sliding Doors and Series 52 Hinged Doors supports the library's design by creating a seamless flow between spaces, fostering a sense of openness. These doors allow natural light to permeate throughout the building, creating tranquil and welcoming spaces perfect for studying or reading.

Together, these features enhance functionality, aesthetics, and energy efficiency, making them ideal for modern architectural designs focused on comfort and sustainability. The result is a welcoming sanctuary and a quiet retreat away from the city's hustle and bustle.



For the full gallery, visit: [awsaustralia.com.au](http://awsaustralia.com.au)

Architect: Six degrees. Builder: Buildcorp. Photographer: Kane Multimedia

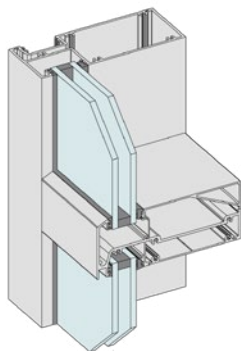

### **SERIES 626 ELEVATE™ DOUBLE GLAZED FRONTGLAZE™**

- × Series 626 FrontGLAZE™ shopfront framing 150mm x 60mm with the glazing pocket close to the front face.
  - × The 28mm deep glazing pocket caters for glass installation and 12mm bite as required by IGU manufacturers.
  - × Reinforced tall glazing beads to tolerate high wind loads.
  - × True captive glazing wedge on one side. In elevated installations this allows you to glaze and reglaze from inside the building, no need for scaffolding.
- Maximum Panel Height: Various  
Maximum Panel Width: Various  
Maximum Glass Thickness: ≤28mm  
SHGC Range: 0.21 - 0.7  
Uw Range: 2.5 - 3.7



SMB Windows supplies Australian made, locally manufactured aluminium windows and doors for Residential, Architectural and Commercial projects. Our range includes high performance and energy efficient options to ensure style for generations to come.

Phone: 03 9763 3106 | Web: [smbwindows.com.au](http://smbwindows.com.au)

